

# ALIDOS SLIDING DOOR / SLIDING DOOR + FIXED SIDE

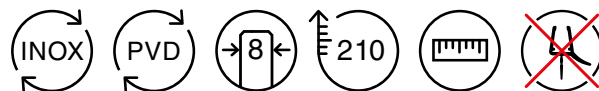

## Standard features

- > Made of Polished or Brushed **Stainless Steel**
- > Available in stainless steel in 4 PVD finishes
- > 8 mm **tempered glass**
- > Recessed and fixed side versions
- > **Standard height 210 cm**
- > **No plastic gaskets**

## Optional with extra charge

- > Made to measure heights - not yet available
- > "Soft Close" - not yet available
- > Coloured, reflective or extra-clear glasses - ask for feasibility
- > Matt glasses - see current price list, ref. Arbatax collections
- > Accessories - see current price list

## DOOR

### PRICE STEP

FROM 108 TO 119 CM
FROM 120 TO 129 CM
FROM 130 TO 139 CM
FROM 140 TO 149 CM
FROM 150 TO 159 CM
FROM 160 TO 169 CM
FROM 170 TO 179 CM
FROM 180 TO 189 CM
FROM 190 TO 200 CM

H 210 CM	
ART.	FIXED GLASS WIDTH (*)
700ALS	15
701ALS	15
702ALS	30 (15)
703ALS	30 (15)
704ALS	30 (15)
705ALS	45 (15, 30)
706ALS	45 (15, 30)
707ALS	45 (15, 30)
708ALS	40 (15, 30)

## FIXED SIDE

### PRICE STEP

UP TO 69 CM
FROM 70 TO 79 CM
FROM 80 TO 89 CM
FROM 90 TO 99 CM
FROM 100 TO 109 CM
FROM 110 TO 119 CM

H 210 CM	
	ÀRT.
	300FIS
	301FIS
	302FIS
	303FIS
	304FIS
	305FIS

Fixed sides wider than 120 cm are available with special packaging.

## STAINLESS STEEL PVD FINISHES



**Black** Polished/Brushed    **Light Gold** Polished/Brushed    **Bronze** Brushed    **Copper** Brushed

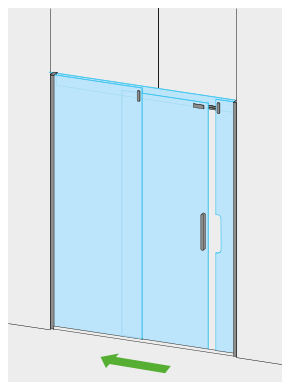

**DOOR FOR NICHE**  
MOD. WITH HANDLE ON THE RIGHT

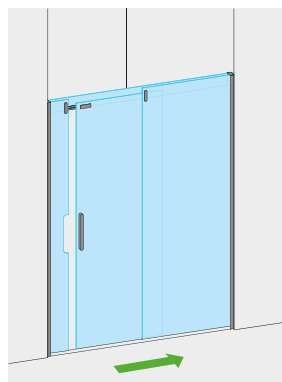

**DOOR FOR NICHE**  
MOD. WITH HANDLE ON THE LEFT

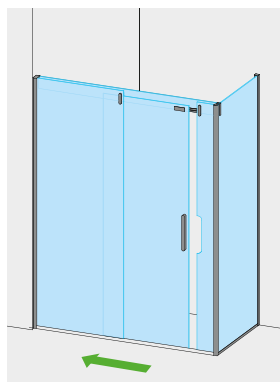

**DOOR + FIXED SIDE**  
MOD. WITH HANDLE ON THE RIGHT, FIXED SIDE IN RIGHT CORNER

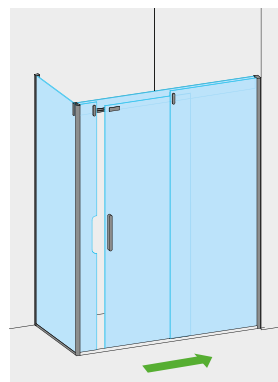

**DOOR + FIXED SIDE**  
MOD. WITH HANDLE ON THE LEFT, FIXED SIDE IN LEFT CORNER

\* You can choose, without extra charge, the width of the small glass where the door closes, from the following options: 15 cm, 30 or 45 cm. In order to have enough entry span, the glass of 30 and 45 centimeters can only be used from a certain width.

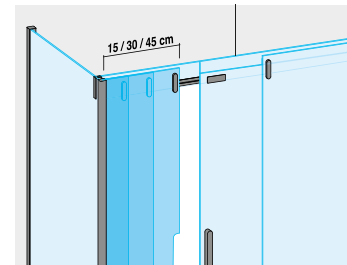

**PLEASE NOTE:** the total height of the shower screen is 210 cm including the upper horizontal fixed glass. The height entrance span is 200 cm.

## NON REVERSIBLE MODEL

To complete the order please specify:

- > the recess size of the niche at the three heights (sliding door for niche)
- > the outer dimensions of the shower tray, and type of installation of the shower tray (sliding door + corner fixed side)
- > the position (right or left) of the handle (sliding door for niche)
- > the position (right or left) of the fixed side (sliding door + corner fixed side)
- > the Stainless Steel finishing (polished, brushed or in PVD finishes)
- > the glass: clear, extra-clear, matt (other models available on request)

Extensibility: ± 1 cm from the size indicated on confirmation of the order

